

# INSTALLATION AND SERVICE MANUAL

**LIGMAN**  
LIGHTING USA

For installation of Abacus 1,2,3 wall light LED.  
Model. UAB-30001, UAB-30002 and UAB-30003.

## Product drawing (dimensions) SUITABLE FOR WET LOCATIONS

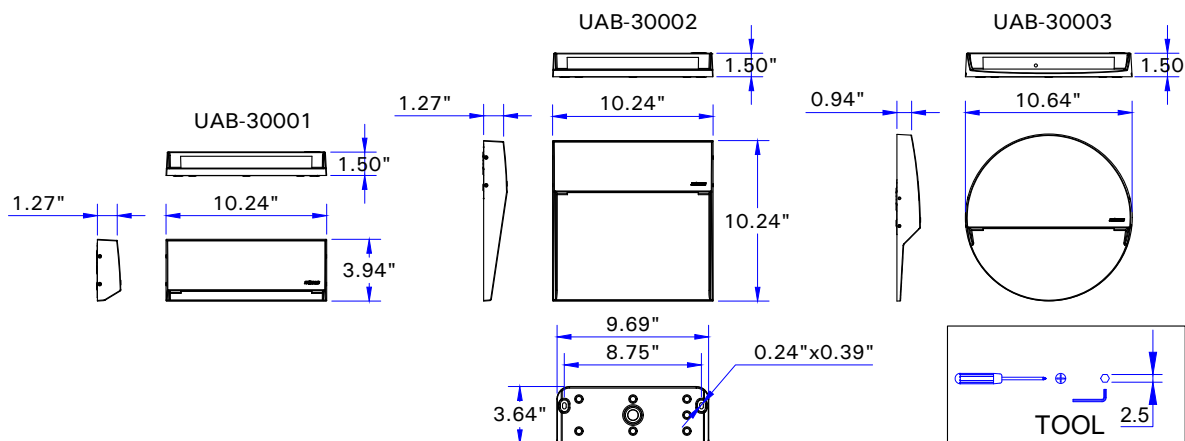

### NOTE

Mounts over  
a 3" or 4" Octagonal  
Junction box.

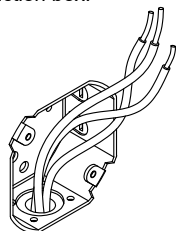

①

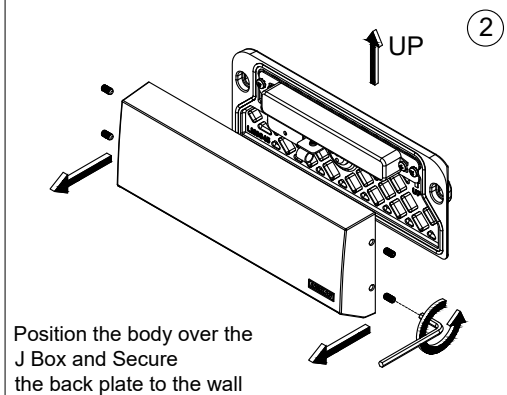

②

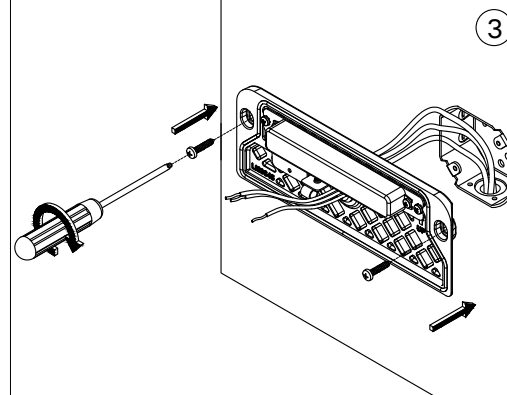

③

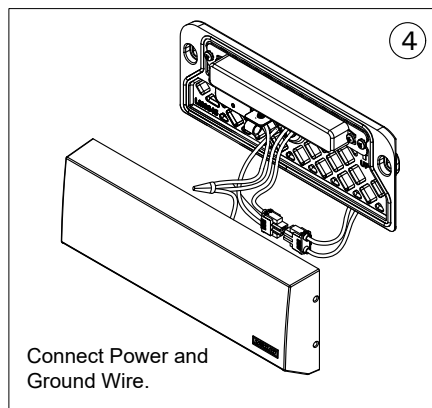

④

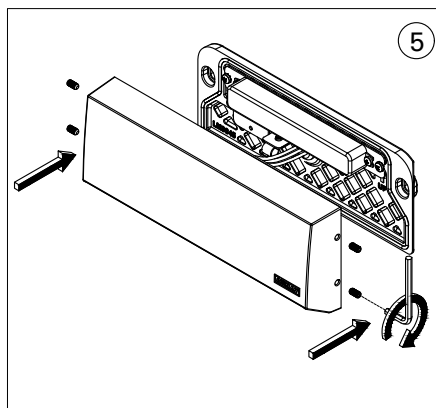

⑤

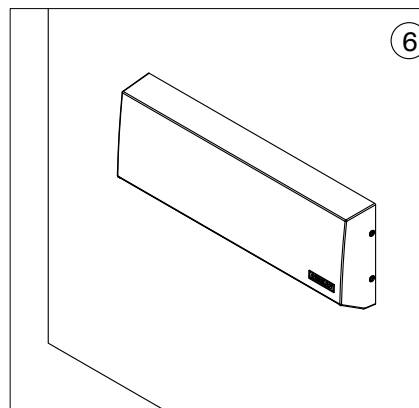

⑥

### Notice to Installer

#### Wiring Instruction ⚠ Warning:

- Risk of Fire and Electrical Shock, This fixture must be installed only by a qualified electrician, Installation must adhere to the National Electrical Code (NEC) and all applicable local and federal regulations.
- Always disconnect power before servicing the fixture.

**Ligman Lighting USA**

7144 NE Progress Court, Hillsboro  
Oregon, 97124, USA  
Tel : 503 645 0500 | Fax : 503 645 8100